

User Manual

Product parameter

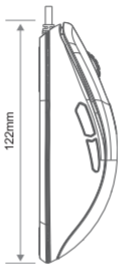

Front View



Left View

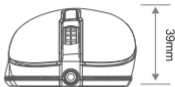

Head View



End View

Basic parameter

Connect: wired USB

Surface treatment: skin-similar

Color: RGB

DPI: 600/1200/2400/3200/4800/10000

Power consumption:100mA(max)

Cable:1.8M

Mouse weight(g):135+/-5g

Dimension:122*66*39MM

Buttons: left/right/scroll wheel/DPI+/DPI-/forward/backward

Buttons/frequency/ resolution:

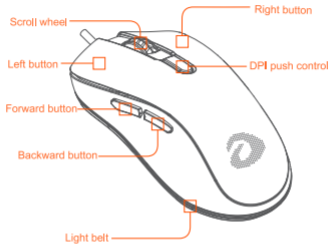

Mouse installation:

Plug mouse USB into computer USB.





1. 4 steps for frequency adjustment through driver

125Hz, 250Hz, 500Hz, 1000Hz(Default: 500Hz)

2. By default DPI is adjustable in 6 steps by DPI+/- button.(default:1200)

Blue (600dpi) Red (1200dpi)

Green (2400dpi) Yellow (3600dpi)

Cyan (4800dpi) Purple(10000dpi)

Colors above are default color

3.Lighting switch function

- Press backward+scroll button 3s the light flash 3 times means start setting.
- Only click left button to change backlight effect.
- Only click right button to change backlight color.
- Scroll forward increase brightness, scroll backward decrease brightness.
- Default backlight effect is waving mode.
- Press backward+scroll button 3s light flash 3 times quit setting.

Diver interface

Download driver from Dareu's official website (www.dareu.com) and install it on computer.

*Picture is for reference only.



EM908

Dongguan Togran Electronics Technology Co., Ltd
Add: No.262 Shidan Rd, 3rd Industrial Park, Juzhou Area,
Shijie Town, Dongguan City, China 523290

Tel.: +86 769 8630 8806 Fax: +86 769 8630 8826

Email: Info@dareu.com CS@dareu.com

Web: www.dareu.com